

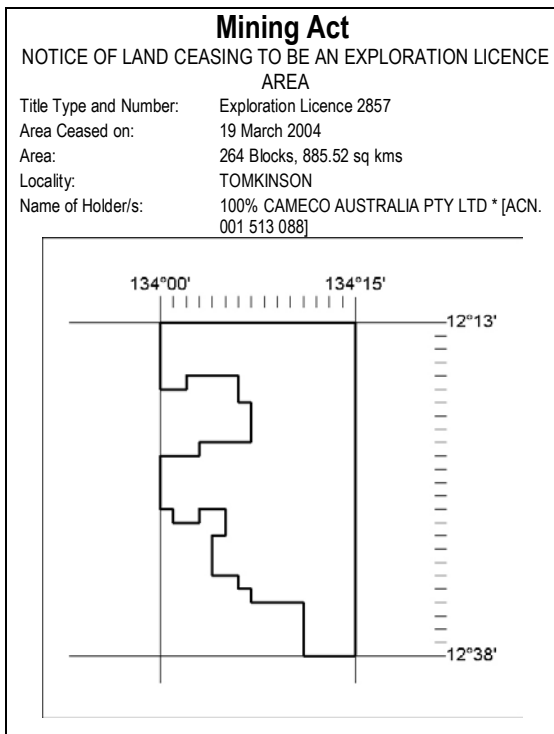

**MN12/04**

**DARWIN**

**24 March 2004**



118/04

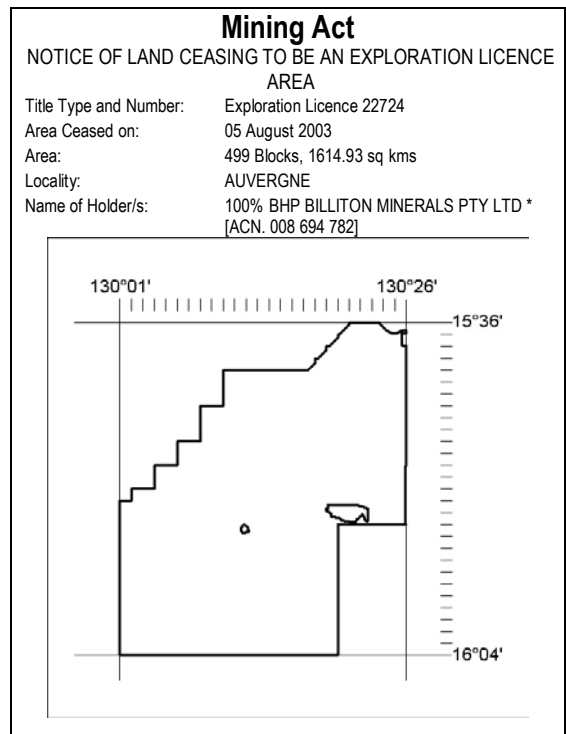

120/04

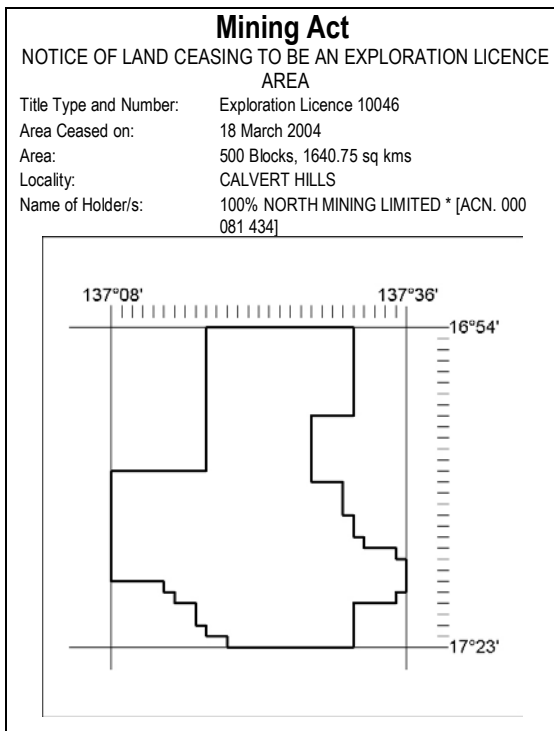

119/04

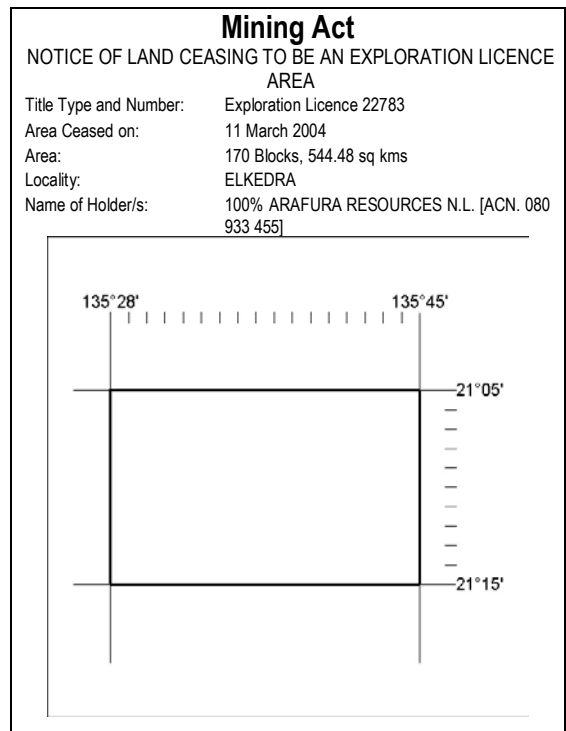

121/04



**MN12/04**

**DARWIN**

**24 March 2004**

## Mining Act

### NOTICE OF LAND CEASING TO BE AN EXPLORATION LICENCE AREA

Title Type and Number: Exploration Licence 23651  
 Area Ceased on: 10 March 2004  
 Area: 103 Blocks, 317.99 sq kms  
 Locality: BARROW  
 Name of Holder/s: 100% TANAMI EXPLORATION NL \* [ACN. 063 213 598]

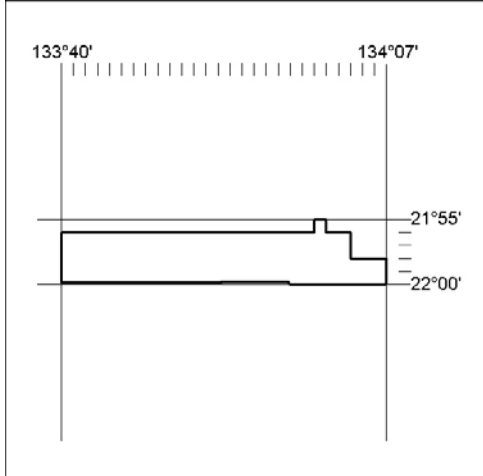

122/04

## Mining Act

### NOTICE OF LAND CEASING TO BE A MINING TENEMENT

Title Type and Number: Mineral Claim (Central) 763  
 Area ceased on: 31 December 2002  
 Area: 25 Hectare  
 Locality: TENNANT CREEK  
 Name of Holder/s: 100% NEWMONT WILUNA GOLD PTY LTD\* [ACN. 009 751 795]

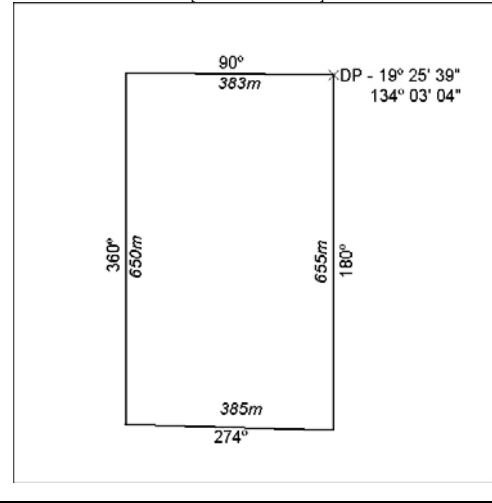

124/04

## Mining Act

### NOTICE OF LAND CEASING TO BE A MINING TENEMENT

Title Type and Number: Mineral Claim (Central) 346  
 Area ceased on: 13 January 2003  
 Area: 20 Hectare  
 Locality: TENNANT CREEK  
 Name of Holder/s: 69% NEWMONT WILUNA GOLD PTY LTD\* [ACN. 009 751 795], 31% GIANTS REEF MINING LIMITED\* [ACN. 058 436 794]

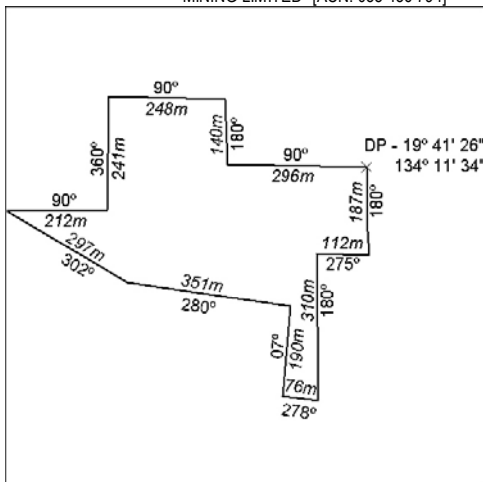

123/04

## Mining Act

### NOTICE OF LAND CEASING TO BE A MINING TENEMENT

Title Type and Number: Mineral Claim (Central) 764  
 Area ceased on: 31 December 2002  
 Area: 22 Hectare  
 Locality: TENNANT CREEK  
 Name of Holder/s: 100% NEWMONT WILUNA GOLD PTY LTD\* [ACN. 009 751 795]

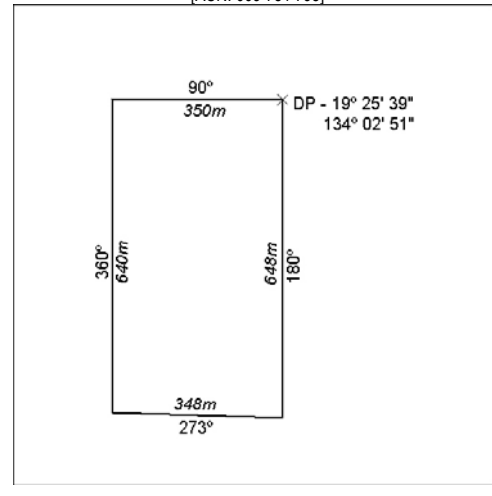

125/04



**MN12/04**

**DARWIN**

**24 March 2004**

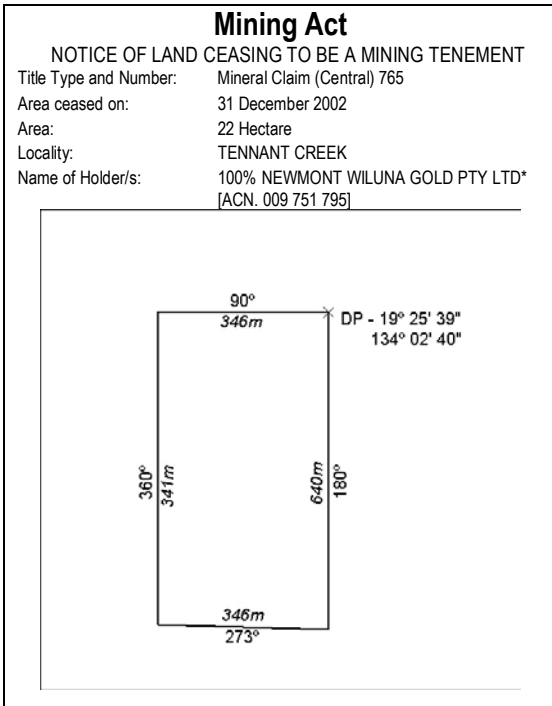

126/04

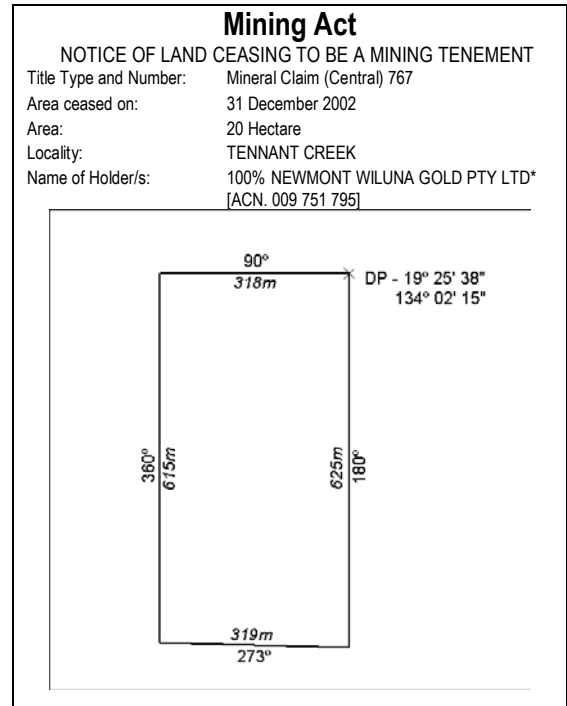

128/04

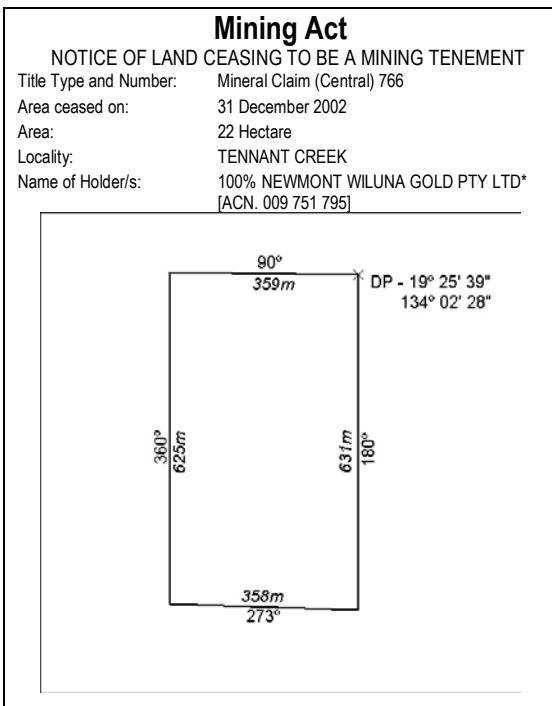

127/04

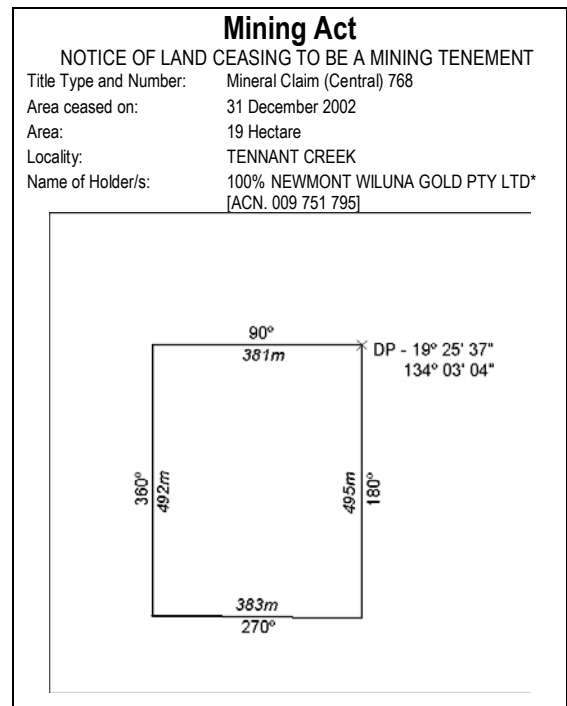

129/04



**MN12/04**

**DARWIN**

**24 March 2004**

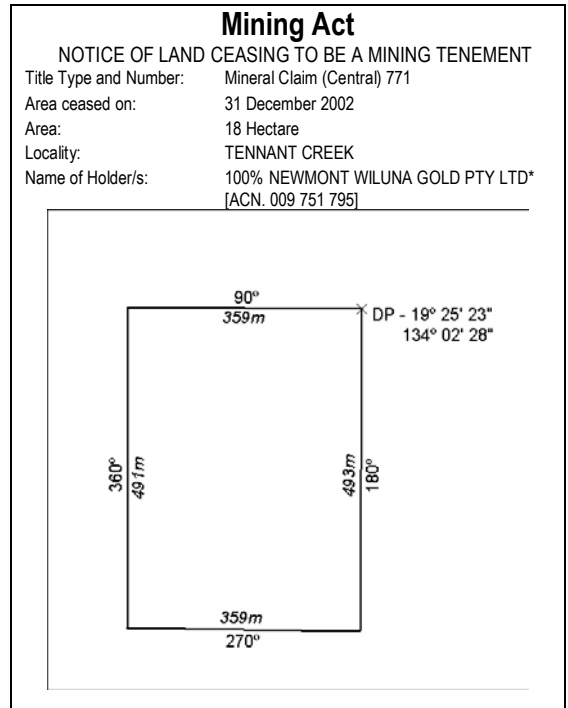
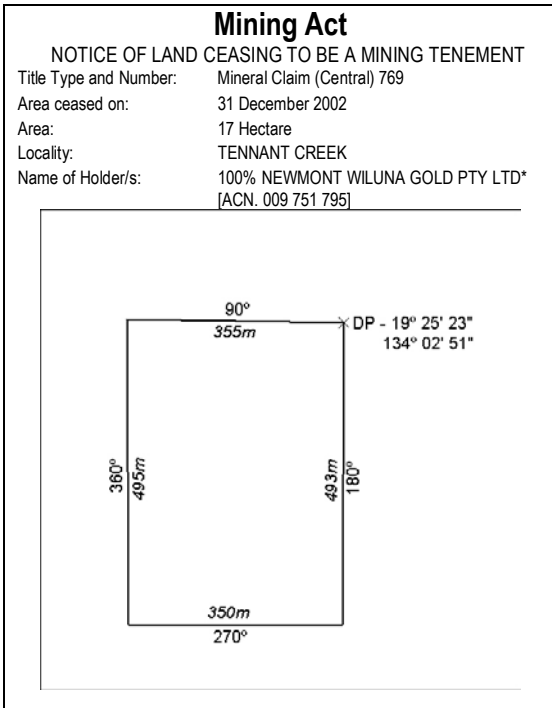

130/04

132/04

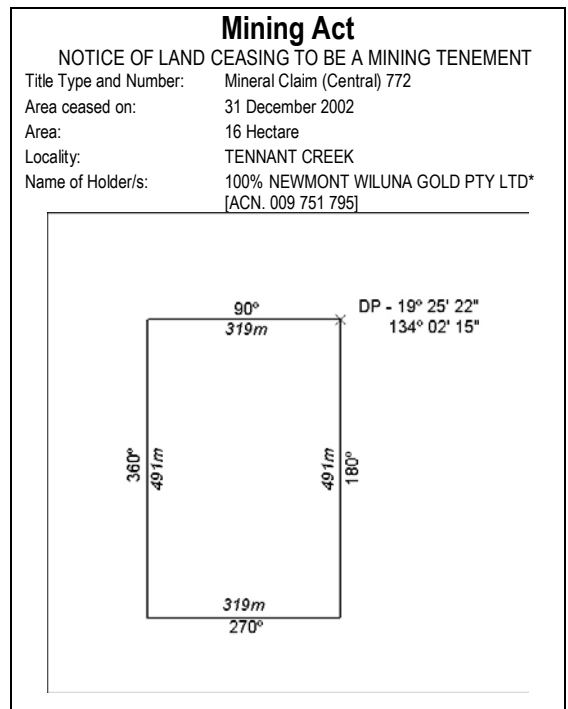
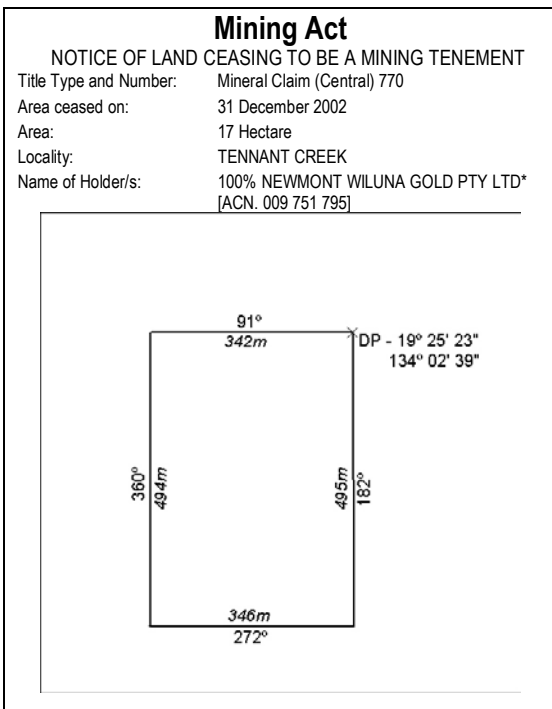

131/04

133/04



**MN12/04**

**DARWIN**

**24 March 2004**

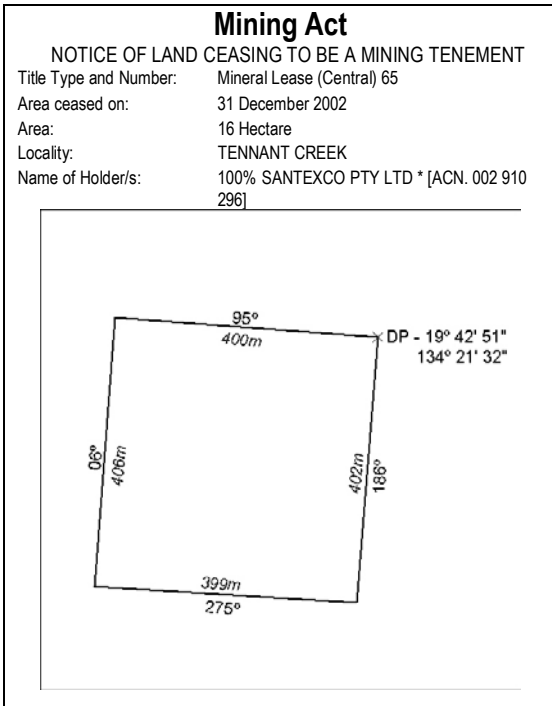

134/04

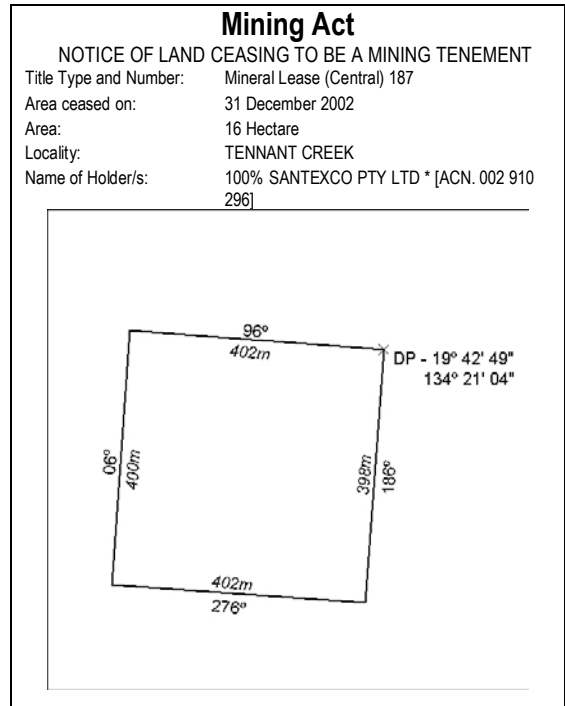

136/04

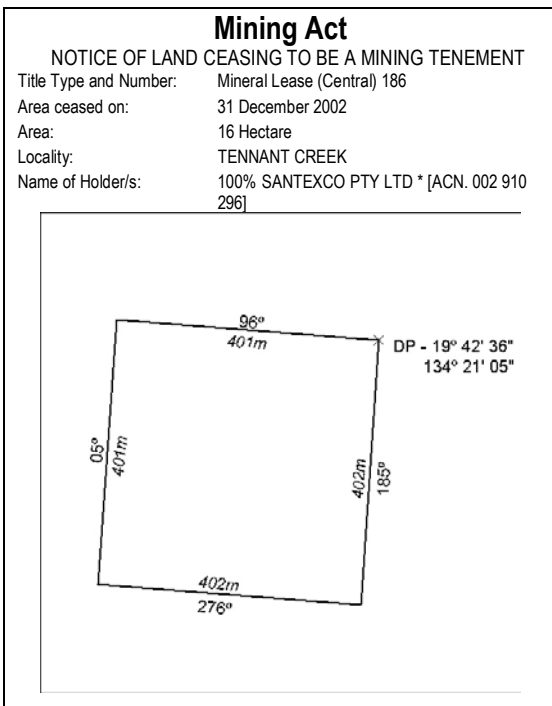

135/04

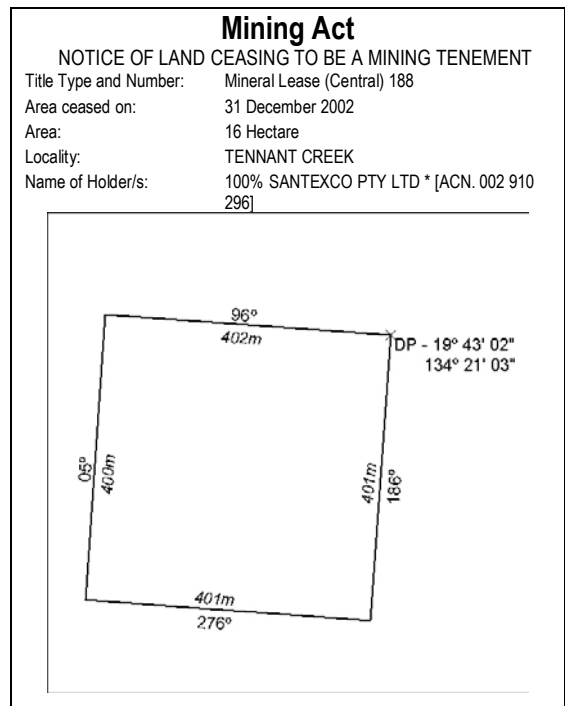

137/04

**MN12/04**

**DARWIN**

**24 March 2004**

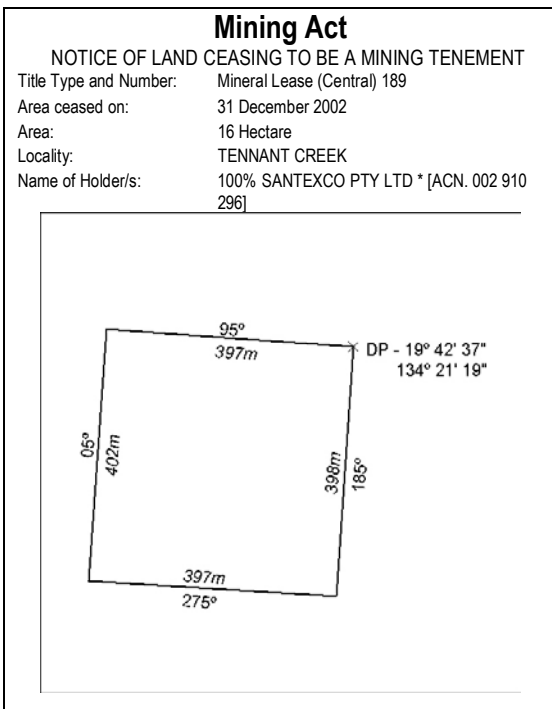

138/04

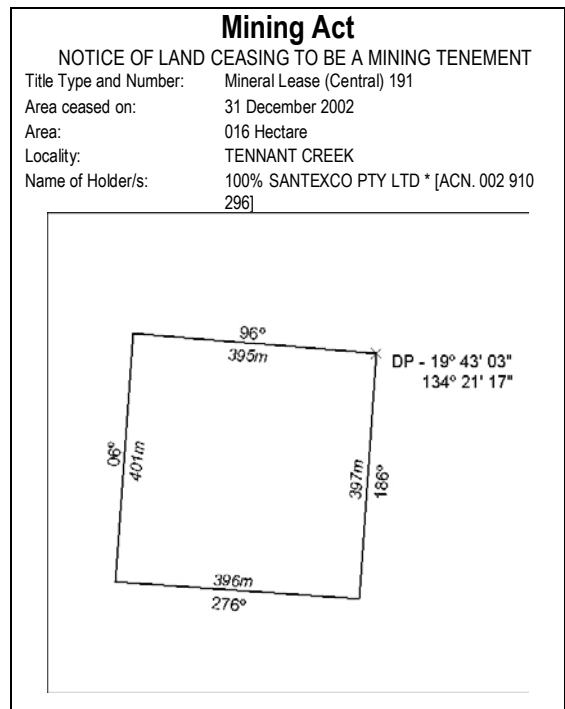

140/04

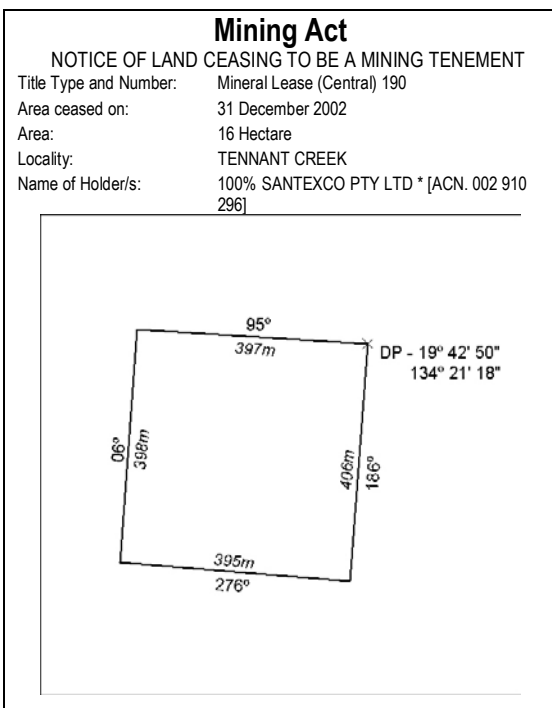

139/04

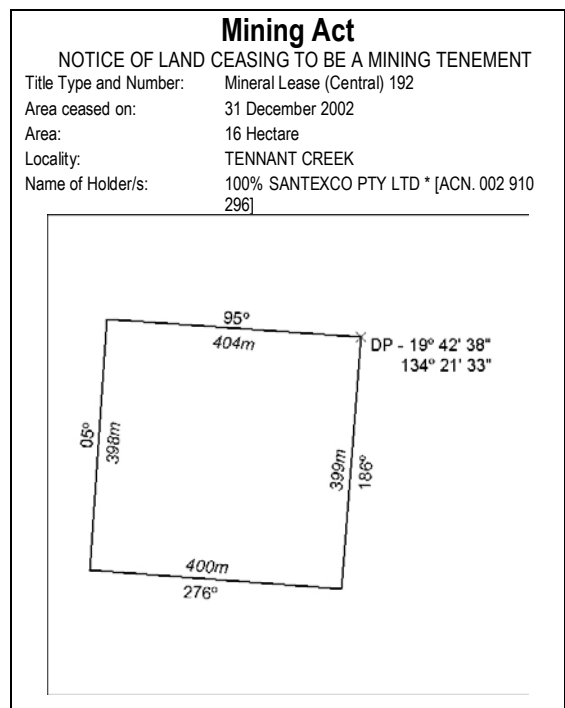

141/04

**MN12/04**

**DARWIN**

**24 March 2004**

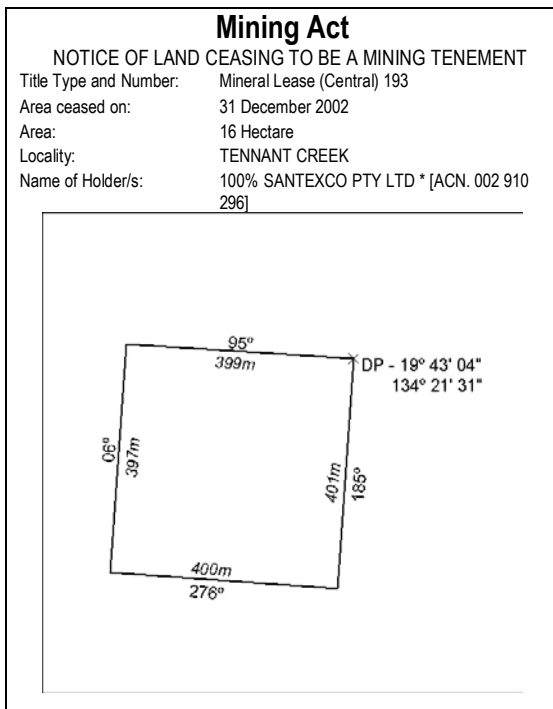

142/04

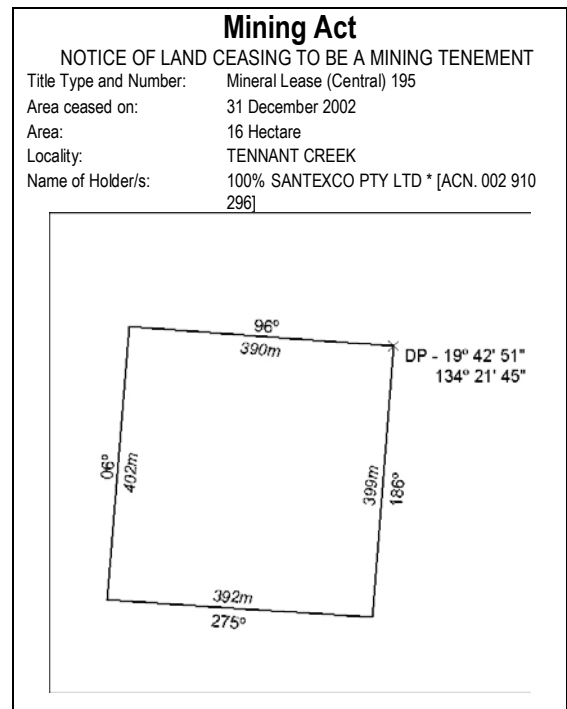

144/04

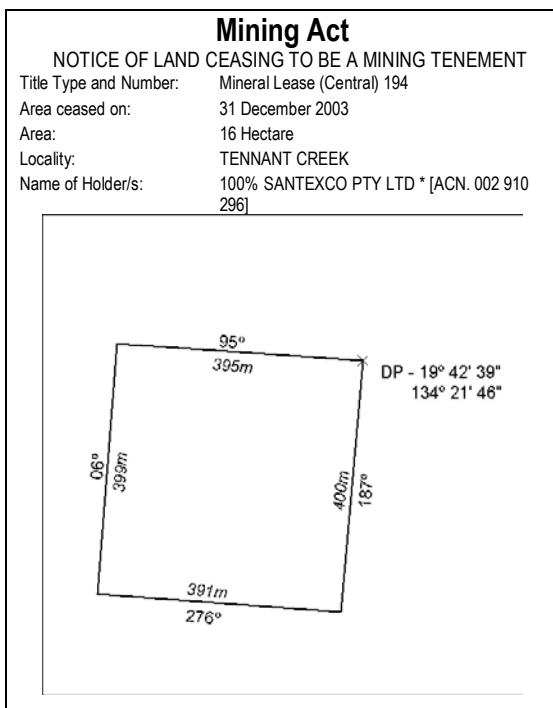

143/04

### CORRIGENDUM

Notice Number 55/04 appearing on page 2 of MN06/04 dated 11 February 2004 is amended by omitting the number of blocks referred to in that notice and substituting it with 159 blocks (464.93 sq kms).

145/04

### CORRIGENDUM

Notice Number 56/04 appearing on page 2 of MN06/04 dated 11 February 2004 is amended by omitting the number of blocks referred to in that notice and substituting it with 178 blocks (525.48 sq kms).

146/04